

ART. 9625

Riduzioni M/F, aisi 316 / A4

Hexagonal bushing M/F, aisi 316 / A4

Esecuzione: Microfusione

Execution: Microcasting

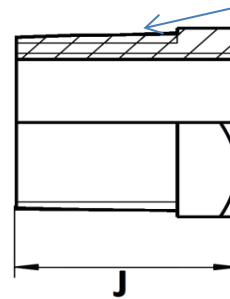
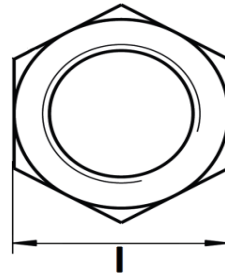

Filettatura: conforme a EN 10226-1 (EX ISO 7-1)

(filetto maschio conico, filetto femmina cilindrico)

Conicità 1:16 sul diametro

Angolo del filetto 55°

Pressione massima d'esercizio 150Lbs (Libbre)=10,34 BAR PN10

Thread: according to EN 10226-1 (EX ISO 7-1)

(conical male thread, cylindric female thread)

Taper 1:16 on diameter

Angle of threads 55°

Maximum operating pressure 150 lbs = 10,34 Bar PN 10

Codice Articolo
Number

Item

Maschio
Male

Femmina
Female

DN/ID

I
(mm)

J
(mm)



Box



Master carton

Codice Articolo Number	Item	Maschio Male	Femmina Female	DN/ID	I (mm)	J (mm)	Box	Master carton
9625-4-1/4*1/8		1/4"	1/8"	8-6	14/14,5	14/14,5	5	800
9625-4-3/8*1/4		3/8"	1/4"	10-8	18	15/16	5	800
9625-4-1/2*3/8		1/2"	3/8"	15-10	21,4/22,5	18,5/19,5	5	600
9625-4-3/4*1/2		3/4"	1/2"	20-15	27/28	21	5	400
9625-4-1*3/4		1"	3/4"	25-20	33,9/35	23,5/24	5	200
9625-4-1-1/4*1		1"1/4	1"	32-25	42,7/44	26,5/27	5	120
9625-4-1-1/2*1-1/4		1"1/2	1"1/4	40-32	48,6/49,5	26,5/27	2	100
9625-4-2*1-1/2		2"	1"1/2	50-40	60,5/61,5	31/31,5	2	50